



## 2021 Silicon Valley Open

Hosted by Peninsula SC  
Solar4America Ice at San Jose  
1500 South Tenth Street  
San Jose, CA 95112  
August 6-7, 2021

**Entry Deadline: July 10, 2021, 11:59 PM (PDT)**

Visit our website at <http://www.peninsulaskatingclub.org>

**Online Registration for Singles Events Through EntryEeze.com**

**Solo Dance Events Through EMS**

*Sanctioned by:*



# 2021 Silicon Valley Open

2021 Silicon Valley Open will be conducted in accordance with the rules and regulations of U.S. Figure Skating, as set forth in the [current rulebook](#), as well as any pertinent updates that have been posted on the U.S. Figure Skating [website](#).

This competition is open to all eligible, restricted, reinstated or readmitted persons as defined by the Eligibility Rules, and who are currently registered member of a U.S. Figure Skating member club, a collegiate club or who is an individual member in accordance with the current rulebook. Please refer to the current rulebook for non-U.S. citizens. The Chief Referee's interpretation of the rules and decisions on all questions not covered by these rules is final.

Officials' travel expenses will be reimbursed in accordance with rule 2150 (as referenced in 3038).

## **COVID-19 INFORMATION:**

- **All attendees are always required to properly wear face coverings** over their nose and mouth and secured under their chin while in a facility. This is not only for your protection, but for the protection of others and is applied to all attendees.
- **Social distancing is required.** Separate pathways will be established within the venue (minimizing crossover and contamination). Spectators are asked to remain in designated seating areas and avoid gathering around the rink entrances and exits.
- **Spectator/Coach:** All athletes may be accompanied by ONE coach. There will be only one coach credential allowed per registered skater. All athletes 17 years and younger may be accompanied by a spectator who is over 18 years of age and is an immediate family member.
- **U.S. Figure Skating Waivers are a requirement for ALL athletes.** For skaters competing in events for which EntryEeze registration is required, the online waivers must be completed via [Members Only](#) before the entry deadline, instruction [here](#).
  - o **Solo Dance entrants will complete the skating waiver in EMS.**

**SERIES INFORMATION:** 2021 Silicon Valley is approved by U.S. Figure Skating as part of the Solo Dance Series. Please refer to the [2021 Solo Dance Series Handbook](#) for current Series rules, levels, music, costume, and event requirements, and selected pattern dances.

## **EVENTS OFFERED:**

- Adaptive Basic Skating
- Juvenile - Senior Singles Short Program
- Snowplow Sam – Basic 6 Program with Music
- Pre-Free Skate – Free Skate 1 – 6 Program with Music
- Excel Beginner – High Beginner Singles Free Skate
- No-Test – Senior Singles Free Skate
- Adult Pre-Bronze – Masters Singles Free Skate
- Solo Dance Pattern Dance (Series)
- Solo Dance Combined Dance (Series)
- Solo Dance Shadow Dance (Series)

**ELIGIBILITY/TEST LEVEL:** Competition level is the highest test passed as of the entry deadline in the discipline the skater is entering. Entrants may skate one level above that for which they qualify, but they may not skate down in any event. For Solo Dance Events, please refer to the 2021 Solo Dance Handbook for entry

rules, test requirements and restrictions.

**Age restrictions/requirements:** Singles free skate events (well-balanced program) have the following requirements:

Juvenile: Girls – 12 years or younger; Boys – 13 years or younger

Open Juvenile: Girls – 13 years or older; Boys – 14 years or older

Intermediate must be under the age of 18

Adults must be 21 years or older

Skaters entering Pre-Juvenile and lower events will be divided as closely as possible by age should the number of entries warrant more than one group.

Adaptive Basic Skating, and all Solo Dance events will *not* be divided by gender except at the discretion of the Chief Referee if appropriate. Adult events may not be divided by gender if necessary to create competition.

Juvenile/Open Juvenile and higher singles events will be divided by gender. For all lower-level singles events, free skate events will be divided by gender except when there is only one entry and the entrant has agreed to compete in an equivalent event against skaters of the opposite gender.

Open Juvenile, Pre-Juvenile and lower singles events as well as all Excel events will be divided into groups when more than 24 skaters are entered. Smaller groups, particularly for lower levels, are permissible at the discretion of the Chief Referee. Solo dance will follow the National Solo Dance Guidelines with regards to groups. There will be no final rounds for these events in the case of multiple groups.

The chief referee reserves the right to request competitor's proof of age for all age-restricted events.

#### **ENTRYEEZE COMPETITION REGISTRATION:**

All Singles entries will be accepted on EntryEeze with credit card only. Accepted credit cards are Visa, MasterCard or Discover. Registration link is available at <http://www.peninsulaskatingclub.org>.

An additional 3% processing fee will be added to the skater's total at check-out to cover credit card processing fees. **Credit card processing fees will not be refunded under *any* circumstances.**

Skaters must include their U.S. Figure Skating/LTS member number and home club. Entry eligibility will be confirmed with the skater's home club and coach through EntryEeze. **Please list the coach accompanying you to SVO as your Primary Coach. This will be the only coach that we will credential for you.** All competitors registering on EntryEeze must complete the US Figure Skating online waivers available on Members Only (Waiver & Release, Medical Consent and Media Release).

**Registration Deadline: 07/10/2021 at 11:59 PM (PDT)**

**Late Entries** will be allowed at the discretion of the LOC and a one-time late fee of \$25 will be assessed at checkout. Skaters with late entries must email their music and PPC (if applicable) to the Registrar to complete registration.

#### **EMS REGISTRATION – SOLO DANCE EVENTS ONLY:**

Solo Dance Entries will be accepted via [EMS](#) with credit card only.

Each transaction includes a 3% credit card fee. **Credit card processing fees will not be refunded under *any* circumstances.**

**Registration Deadline: 07/10/2021 @ 11:59 PM (PDT)**

1. Go to <https://m.usfigureskating.org>
2. Enter your U.S. Figure Skating number and password
  - a. If you need assistance with your member number and password, contact Member Services at [memberservices@usfigureskating.org](mailto:memberservices@usfigureskating.org).
3. Click EMS then “Competition Registration”
4. Choose “2021 Silicon Valley Open” from the list of nonqualifying competitions.
  - a. If you need assistance completing your registration, contact [productsupport@usfigureskating.org](mailto:productsupport@usfigureskating.org).

**\* Shadow Dance event only:** Only one partner will complete registration for the team on EMS. During the registration process, you will be asked to identify your partner and verify their test information. The registered partner will be responsible for managing all aspects of the competition including music/PPC upload, etc.

**FOREIGN SKATERS:**

Non-U.S. skaters intending to register for this competition must set up a non-member account prior to registering for the competition ([click here for HOW TO](#)). This can be done by choosing the “Create Account (Non-Member)” option on the [Members Only](#) login page.

**Mandatory Athletes:**

Athletes age 18+ as of the competition start date who will be competing on a team (e.g., shadow dance) with at least one minor athlete must complete SafeSport training prior to the entry deadline.

Minor Athletes who turn 18 mid-season are encouraged to seek parental consent to take the online SafeSport training early to avoid any disruptions in their ability to participate as the training is required upon turning 18. The athlete will not be SafeSport compliant until they have completed the training and their Members Only portal reflects completion. Please email [safesport@usfigureskating.org](mailto:safesport@usfigureskating.org) for instructions or questions regarding parental consent.

**SINGLE ENTRIES:** Two entrants are required to hold each event, except Adapted Basic Skating where **only one entrant is allowable**. During registration, each skater competing in events that are not Solo Dance or Adapted Basic Skating events will be asked the following “survey” question: “If you are the only entrant in any of your events, which of the following options would you prefer: skate the event as the only entrant, compete in an equivalent event against skaters of the opposite gender (Pre-Juvenile and lower free skate only), or withdraw from the event with a full refund of the entry fee for the withdrawn event.” Your answer to this question will be considered final and binding and will help the Chief Referee to make the schedule as quickly as possible.

**REFUND POLICY:** Entry fees will be refunded if no competition exists; or the event is cancelled; and to solo entrants in an event who decline the offer to skate as outlined above. Refunds will be given to entrants who believe they may have been exposed to, or have any symptoms of, COVID-19 or if there is a death in the skater’s immediate family. At the discretion of the LOC, if an entry is withdrawn before the close of entries, the entry fee may be returned. All requests for entry refunds must be received by the Competition Committee no later than 10 days after the 2021 Silicon Valley Open Competition is held.

Credit card processing fees will not be refunded under *any* circumstances.

**ADDITIONAL FEE-RELATED POLICIES:** All fees including late fees, must be paid by 11:59 pm on August 2, 2021 (PDT). If a skater has unpaid fees after that date, the Local Organizing Committee may withdraw the skater from all entered events. No refund will be available if the Local Organizing Committee withdraws a skater due to unpaid fees. No payments will be accepted at the competition.

Contested credit card charges will incur a \$25.00 fee. This fee is nonrefundable.

**SCHEDULE:** Competitors may be scheduled on any day or time during the announced dates of the competition. The competition schedule will be posted on-line before the start of the competition. Participants will be notified via email once available.

**FACILITIES:** 2021 Silicon Valley Open will be held at Solar4America Ice at San Jose, 1500 S. 10th Street, San José, CA 95112, (408) 279-6000. Each rink is 200' x 85' with slightly curved ends. Outside food is not allowed. **\*NOTE: No one will be admitted into the facility without a face mask.**

**MUSIC UPLOAD:**

Competitors participating in Solo Dance events with music are required to upload their music to EMS no later than **7/24/2021 by 11:59 PM (PDT)**. After this date, skaters will be locked out of this feature and subject to a **\$20 late fee**. The late fee will automatically be added to each skater's cart who doesn't meet this requirement by the deadline.

All competitors in events other than Solo Dance must submit their music in mp3 format through EntryEeze no later than **7/24/2021 by 11:59 PM (PDT)**. **After this date, a late fee of \$20 will be assessed.** Late fees will not be removed under any circumstances.

All music must meet the following criteria. If you have questions about what format you have, please contact your coach and get a new version of your music that meets the criteria listed below.

**MUSIC CRITERIA:**

- File Format: MP3
- Bit Rate: 192 kbps or higher and Sample Rate: 44,100 kHz
  - This will be verified by the music chair and they may request you upload a corrected file.
- Leaders and trailers (the silence or "dead space" before and after the actual start and end of the program music) may not exceed two (2) seconds. Excessive leaders and trailers may disrupt the playing of the music during competition.

Competitors must also bring a copy of their competition music on CD as a backup in case of technical difficulties and must be available rink side during the competition. Only CDs (standard CD-R format only) will be accepted for backups and must be clearly marked with the competitor's name, event, and running time and must have only one track on each CD. Please note that no CDs will be accepted at the competition unless requested by the music desk due to an equipment malfunction.

**PLANNED PROGRAM CONTENT (PPC) – IF IJS:**

Competitors participating in Solo combined dance events are required to submit their PPC in EMS no later than **11:59 PM (PDT) on 7/24/2021**. After this date, skaters will be locked out of this feature in EMS and subject to a **\$20 late fee**. The late fee will automatically be added to each skater's cart who doesn't meet this requirement by the deadline.

Competitors participating in IJS short program and/or free skate events must submit their PPC in EntryEeze no later than **11:59 PM (PDT) on 7/24/2021**. Skaters who have not submitted their PPC by this date will be charged a \$20 late fee.

Late fees will not be removed under any circumstances and must be paid before 11:59 pm on August 2, 2021 (PDT).

**WARM-UP:** Warm-up times will be a minimum of three minutes and a maximum of six minutes. Warm-up groups may be increased and/or combined at the discretion of the Chief Referee. Warm-up groups may be adjusted up until the beginning of the event.

**LIABILITY:** U.S. Figure Skating, Peninsula SC and Solar4America Ice in San Jose accept no responsibility for injury or damage sustained by any participant in this competition. This is in accordance with Rule 1600 of the official U.S. Figure Skating Rulebook. All entrants, their parents and guardians and officials agree to assume all risks of injury or illness to their person and property resulting from, caused by or connected with, the conduct and management of the competition, and to waive and release any and all claims that they may have against any officials, U.S. Figure Skating, Peninsula SC and its officers, Solar4America Ice San Jose and its staff.

**ONSITE CHECK-IN:** Check-in will open one hour before the first event and run through the last event of each day of competition. The registration table will be located at the arena's main entrance. Each skater may be accompanied by one coach. All skaters under 17 years of age may be accompanied by a spectator who is 18 years or older and is an immediate family member. Health screening and/or temperature check may be conducted before entry is permitted.

As of June 15, 2021, Solar4America Ice updated their facility policies and procedures, some of which may not be in compliance with US Figure Skating safety procedures and protocols. We ask that all participants adhere to the guidance set forth in the 2021 SVO Safety Procedures. These restrictions may change going forward and all participants are expected to adhere to the safety guidelines in place on the day of competition. Current Mask Policy signage will be posted at the rink's entry points.

**LOCKER ROOMS AND CHANGING AREAS:**

Locker rooms will not be available to competitors as dressing/changing rooms at this competition. Changing in the restrooms is prohibited. For more information, please visit the [U.S. Figure Skating SafeSport](https://www.usfigure skating.com/safesport) page.

Athletes are advised to arrive at the arena ready (costumes, hair, make-up, etc.). An area to put on skates will be provided.

**PRACTICE ICE:** There is no official practice ice for 2021 Silicon Valley Open. Please contact Solar4America Ice at San Jose ([www.solar4americaiceatsanjose.com](http://www.solar4americaiceatsanjose.com)) for public or freestyle sessions times at (408) 279-6000.

**PHOTO/VIDEO:** Spectators are reminded that **flash photography is dangerous to skaters and is strictly prohibited.** Personal video cameras are permitted but may only be used to film your skater's performance and for personal use only. Only battery-powered video units are allowed; electrical cords, tripods (or similar devices) are not permitted in the arena. **PERSONAL VIDEO FILMING IS ONLY PERMITTED FROM THE AUDIENCE STANDS. FILMING FROM THE COACHING AREA OR HOCKEY BOXES IS NOT ALLOWED.**

**Note, per U.S. Figure Skating policy, photographing and/or recording of any one other than your own skater is strictly prohibited.**

**AWARDS:** Medals will be awarded to 1<sup>st</sup>, 2<sup>nd</sup>, 3<sup>rd</sup>, and 4<sup>th</sup> places and will be presented outside during ice cuts or as soon as possible after the conclusion of each event.

**In the Juvenile through Senior, Adult Gold and Masters Singles Free Skate and Solo Free Dance events, when six or more skaters compete in and complete the event, cash prizes and/or scholarships will be awarded. First place will receive \$150, 2<sup>nd</sup> place will receive \$50 plus a \$100 scholarship, 3<sup>rd</sup> place will receive a \$100 scholarship and 4<sup>th</sup> place will receive a \$50 scholarship. These scholarships may be used for future Peninsula Skating Club competition entries. If any event is split into multiple groups, the overall point totals will be used to determine prize winners.**

**Special Ernie Burden Award:** To honor the memory of Ernie Burden, who was a long time skater, judge and member of Peninsula SC, the Burden family has created an annual award, the Ernie Burden Award. The award will be given to the Novice Men competitor with the highest Interpretation program component score in his free skate. This award is for the competitor to keep. If there is only one competitor in Novice Men free skate, then the award shall be given to the Novice Lady with the highest Interpretation program component score in her free skate.

**OFFICIAL NOTICES:** An official bulletin board will be maintained in the rink for competition notifications such as schedule modifications. **Skating orders and event results will NOT be posted.** It is the responsibility of each competitor and coach to check the bulletin board for any schedule changes and/or additional information. A tentative schedule of events will be posted online prior to the competition. Skaters and coaches will have designated arrival time(s) for their event(s). Please do not arrive late or it may affect your ability to participate in your event. Event results will be posted online.

**TEST CREDIT:** Skaters in the Juvenile through Senior and Adult Silver and Gold FS events that meet the requirements for test credit may sign up for Test Credit on EntryEeze. There is a \$10 fee for the test credit packet. **Please include your email. Signups will not be taken at the competition. Test credit packet will be sent to the provided email address.** Skaters: Please remember that your test credit packet needs to be submitted to your home club test chair for processing.

**IMPORTANT NOTICE FOR ALL COACHES:**

To be a credentialed coach at a sanctioned nonqualifying competition, coaches must meet the compliance requirements listed below and verified by the U.S. Figure Skating. **Each competitor may be accompanied by one coach only.**

With EMS (Solo Dance participants only), a coach must be included within a skater's registration or updated through their EMS Skater Portal via "[My Coaches](#)." The coach(es) declared at the time of registration will be included on the skater's registration confirmation email. If more than one coach is declared, you must notify the registrar which coach will accompany you to SVO. Only one coach credential will be allowed per registered skater.

**EMS Coach Resources may be found here:**

- [My Competitions](#)
- [My Skaters](#)
- [Coach Schedule](#)

\_\_\_\_\_

\_\_\_\_\_

\_\_\_\_\_

**Coach/Choreographer (domestic/non-foreign):**

- ✓ Must be a current full member of U.S. Figure Skating either through a member club or as an individual member.



- ✓ If 18 years or older, must submit information for, proper payment of \$30 and successfully pass a background check. \*
- The background check will be valid for two seasons, the one in which it was completed plus one additional.
- ✓ If 18 years or older, must complete annual SafeSport Training. \*
- The training will be valid for 365 days from date of completion and there is no cost for the training/certification.
- ✓ Must complete the Professional Coach/Choreographer Coaching Education Requirement (CER) through the [Professional Skaters Association \(PSA\)](#).
- ✓ Must submit proof of general liability insurance with limits of \$1 million per occurrence/ \$5 million aggregate.
- ✓ Must agree to the U.S. Figure Skating Code of Ethics. \*
- ✓ Must complete three waivers: 1) Assumption of Risk, Waiver and Release and Indemnification Agreement, 2) Medical Consent and 3) Name and Likeness Release and Consent Agreement. \*
- ✓ If attending a qualifying competition or traveling as a part of Team USA and/or International Selection Pool (ISP), must be a full member of the [Professional Skaters Association \(PSA\)](#).

#### Learn to Skate USA Coach:

- ✓ Must be a current full member of U.S. Figure Skating either through a member club or as an individual member OR Learn to Skate USA instructor membership
- ✓ If 18 years or older, must submit information for, proper payment of \$30 and successfully pass a background check. \*
- The background check will be valid for two seasons, the one in which it was completed plus one additional.
- ✓ If 18 years or older, must complete annual SafeSport Training. \*
- The training will be valid for 365 days from date of completion and there is no cost for the training/certification.
- ✓ Learn to Skate USA Instructor Certification completed OR U.S. Figure Skating compliance coach (details above)

\* Accessible via U.S. Figure Skating Members Only Website:

[www.usfsaonline.org](http://www.usfsaonline.org) → Person Icon  or Account → Member Profile → Compliance

#### Foreign Coach/Choreographer:

- ✓ Required to present the LOC with a letter from their federation verifying they are a member in good standing.

For more information regarding Coach Compliance, please visit the [Coach Compliance](#) page.

**VOLUNTEER INFO:** We need your help. Volunteers are an essential ingredient for running our competitions and supporting our skaters. Becoming a volunteer for SVO is easy - you can sign up at a SignUpGenius [site](#) beginning mid-July.

Most opportunities do not require previous experience, so don't worry if you don't know how to be an ice monitor or run music. Volunteer compliance is only necessary for medical personnel at SVO (see below). Once we receive your sign-up, you will be contacted by our Volunteer Coordinator before SVO to confirm your role and scheduled time(s).



## **VOLUNTEER COMPLIANCE:**

Reminder: compliant positions at all U.S. Figure Skating sanctioned events include key LOC members, locker room monitors and ALL medical event personnel. To be considered compliant, an approved volunteer serving in one of these positions must:

- ✓ Must submit information for, proper payment of \$30 and successfully pass a background check\*
  - The background check will be valid for two seasons, the one in which it was completed plus one additional
- ✓ Must complete annual SafeSport Training
  - The training will be valid for 365 days from date of completion and there is no cost for the training/certification \*

\* Accessible via U.S. Figure Skating Members Only website:

[www.usfsaonline.org](http://www.usfsaonline.org) → Person Icon  Account → Member Profile → Compliance

## **CONTACT INFO:** If you have questions, please contact:

Qian Zhao

Co-Chair

[gazhus@yahoo.com](mailto:gazhus@yahoo.com)

Wei Jing

Co-Chair

[longlat@yahoo.com](mailto:longlat@yahoo.com)

Beth Bottos

Registrar

[registrar@peninsulaskatingclub.org](mailto:registrar@peninsulaskatingclub.org)

## **ADDITIONAL INFORMATION:**

### **Local Hotels:**

Holiday Inn San Jose-Silicon Valley  
1350 North 1st Street  
San Jose, CA 95112  
(408) 453-6200

Hilton San Jose  
300 Almaden Blvd.  
San José, CA 95110  
(408) 287-2100

The Westin San Jose  
302 S Market Street  
San José, CA 95113  
(408) 295-2000

For those traveling by air, U.S. Figure Skating is proud to offer discounted fares to all sanctioned events through a partnership with United Airlines. Visit <https://www.usfigureskating.org/support/sponsors> for more information.

**Tentative schedule:** For planning purposes, a provisional schedule would have short program and solo rhythm dance or pattern dance on Friday and Free Skate/Free Dance on Saturday. For non-qualifying levels, a provisional schedule would have Free Skates on Friday.

For more information, please visit [www.peninsulaskatingclub.org](http://www.peninsulaskatingclub.org)

**PLEASE NOTE:** The rules of the competition may change, subject to current COVID-19 safety guidance. Admission and use of Solar4America Ice in San Jose facilities may be restricted or changed in accordance with current COVID-19 safety guidelines. The number of events, entries and spectators may be limited. Basic health information may be requested and recorded prior to admission into the facility. Social distancing and use of personal protective equipment may be enforced throughout the facility. Your safety is of the utmost importance to us and we request that you follow the guidelines presented at 2021 SVO to protect everyone in attendance.

## SECTION 2: Events Offered and Entry Fees:

SEE CURRENT [RULEBOOK](#) OR [U.S. FIGURE SKATING WEBSITE](#) FOR RULES/REQUIREMENTS.

*Review the charts for requirements and levels. Chart below was updated on March 25, 2021 with the 2021-2022 Singles SP & FS Charts.*

U.S. FIGURE SKATING EVENTS			
SINGLES – Register on EntryEeze	IJS/6.0	1 <sup>st</sup> EVENT	2 <sup>nd</sup> EVENT
<u>Well Balanced Short Program (20/21) , Juv through Senior</u>	IJS	\$105	\$50
<u>Well Balanced Free Skate (21/22) No Test &amp; Pre-Preliminary</u>	6.0	\$90	-
<u>Well Balanced Free Skate (21/22) Preliminary through Senior</u>	IJS	\$105	-
<u>Adult Free Skate (Adult Silver – Master Jr/Sr)</u>	IJS	\$105	-
<u>Adult Free Skate (Pre-Bronze – Bronze)</u>	6.0	\$90	-
COMPETE USA EVENTS -Register on EntryEeze			
<u>Snowplow Sam-Basic 6 Program w/ Music</u>	6.0	\$55	
<u>Pre-Free Skate – Free Skate 1-6 Program w/ Music</u>	6.0	\$75	
<u>Excel Free Skate (Beg. – High Beginner)</u>	6.0	\$75	
ADAPTIVE SKATING – Register on EntryEeze			
<u>Adaptive Basic Skating</u>	6.0	\$25	
SOLO DANCE – Registration on EMS	JUDGING	1 <sup>st</sup> EVENT	2 <sup>nd</sup> EVENT
<u>Solo Dance - Pattern Dance</u>	IJS	\$110	
<u>Solo Combined Dance</u>	IJS	\$125	
<u>Shadow Dance</u>	IJS	\$90 (per couple)	

\*The “2<sup>nd</sup> Event Price” for Singles will only apply if the skater has signed up for both the Short Program and Free Skate.

If a skater has EntryEeze-processed events, scholarship redemptions will be processed as credits to the skater’s unpaid cart. Competitors redeeming scholarships received at 2019 Silicon Valley Open to pay for EntryEeze processed events need to complete registration through EntryEeze and then contact the Registrar before making any payment and no later than 11:59 pm July 10, 2021 (PDT). Credits can only be applied by the Registrar. If the Registrar is contacted after payment is made, credit card processing fees will not be refunded. If a skater has only EMS-processed events, scholarship redemptions will be processed as a check mailed to the skater. Skaters with EMS-processed events must still contact the Registrar to set up the issuance of the check. *All unused scholarships will expire 48 hours before the entry deadline for SVO 2021, are non-transferable, and cannot be exchanged for cash.*

All fees including late fees, must be paid by 11:59 pm on August 2, 2021 (PDT). If a skater has unpaid fees after that date, the Local Organizing Committee may withdraw the skater from all entered events. No refund will be available if the Local Organizing Committee withdraws a skater due to unpaid fees. No payments will be accepted at the competition.



## OPERATIONS & SAFETY PLAN AS OF JUNE 15, 2021

### Contents:

Current State Covid-19 Restrictions .....	Page 1
Overall Event.....	Page 1
Schedule .....	Page 2
Building Access and Layout .....	Page 2
Athletes .....	Page 2
Spectators.. .....	Page 3
Coaches .....	Page 3
Officials .....	Page 3
Volunteers .....	Page 4
Awards .....	Page 4
Disinfecting Process .....	Page 5
Floorplans .....	Page 6

## CURRENT COVID-19 RESTRICTIONS

- As of June 15, 2021, California is expected to fully reopen and lift capacity requirements for most businesses and physical distancing requirements for the public
- However, as of June 14, 2021, Santa Clara County was in the yellow tier for Covid-19 restrictions.
- Since no new orders have been issued by Santa Clara County, we will continue to abide by the capacity restrictions and the latest order of May 18, 2021 from the Santa Clara Health Officer until new directives are issued.
- All Covid-19 guidelines established by U.S. Figure Skating for competitions relating to mask requirements and social distancing will be strictly implemented (including the Revised Policy effective July 1, 2021) as noted in the following sections.

## OVERALL EVENT

- All athletes are required to have signed waivers prior to participating.
- Masks are not required for fully vaccinated people unless specifically required by Solar4America Ice Arena. Masks are required to be worn at all times by all people who are not fully vaccinated, regardless of facility policies. The only exception is for athletes while they are on the ice or warming up outside the rink. Anyone not adhering to this policy will be asked to leave the building immediately – no exceptions.
- Temperature checks and screening questions will be administered daily. No individual will be allowed to enter the building if they have a fever, cough, or have been in contact with someone who tested positive for Covid-19 or was showing Covid-19 symptoms within the last 10 days.
- One (1) Spectator per registered athlete will be admitted for the athlete's competition time. The Spectator must be over the age of 18 and an immediate family member as defined in the U.S. Figure Skating's SafeSport Handbook.
- Skate Orders and Results will be posted Online at: *(insert link)*
- Medals will be awarded for 1<sup>st</sup> through 4<sup>th</sup> places. Awards will be presented outside during ice cuts or as soon as possible after the conclusion of each event.
- Locker Rooms will NOT be available and skaters should come dressed and ready to compete.
- No official practice ice is offered. Unofficial practice ice can be purchased directly with the Solar4America rink.
- Young Athletes or Athletes requiring special assistance will be allowed one Spectator to accompany them into the Skater Prep Area at event time to help get skates on. The Spectator must immediately exit the area and move to the designated arena seating area.
- No outside food/drink will be allowed in the facility.

## SCHEDULE

A detailed schedule for the competition is available here [\(insert link\)](#). Athletes and coaches have designated times for arrival for competition. No individual will have access to the building without appropriate supervision. Volunteers will direct athletes to the appropriate locations for off-ice warm-up, prep, access to the ice and out the building.

## BUILDING ACCESS AND LAYOUT

Separate pathways have been established for Athletes, Spectators, Coaches and Officials to travel through the building with minimal crossover and interaction among the various groups. Athletes will not be permitted to access the building until the designated time per the detailed schedule. Athletes who miss their designated arrival time will be directed the appropriate area in accordance with the detailed schedule. Please refer to the detailed layout for the various designated areas and pathways for Athletes, Spectators, Coaches and Officials. [See floorplan attached at end of Operations and Safety Plan.](#)

## ATHLETES

- All athletes will be subject to temperature checks and screening questions daily.
- Masks are not required for fully vaccinated athletes unless specifically required by Solar4America Ice Arena. However, masks are required to be worn by any athletes who are not fully vaccinated, except when they are on the ice or warming up outdoors.
- Athletes may only bring what they can carry, as they must carry the items as they move from station to station.
- Athletes may collect their credentials from Registration 45 minutes before their event.
- Athletes will enter and exit the ice through designated gates that will be clearly signed.
- Volunteers will direct each group of athletes to the areas designated for off-ice warm-up, prep to put skates on, and to ice access.
- After the prior group has completed skating, the current event group will enter the ice for their warm-up.
- Once the Athlete has completed their program for the event, they must remove their skates, gather their belongings and exit the rink to await results.
- Results will be posted on-line as soon as possible after the event is complete.
- Athletes should meet their Spectators outside the arena after they have completed their program.
- Athletes and Spectators may only return to the Awards area outside the rink to pick up their awards during ice cuts or after the awards have been posted on-line.

## SPECTATORS

- Spectators will be subject to temperature checks and screening questions daily.
- Masks are not required for fully vaccinated Spectators unless specifically required by Solar4America Ice Arena. Masks are required to be worn by Spectators who are not fully vaccinated regardless of the facility policies.
- One (1) Spectator per registered Athlete will be admitted for the athlete's actual competition time. The Spectator must be over the age of 18 and an immediate family member as defined in U.S. Figure Skating's SafeSport Handbook.
- Spectators will be diverted to arena seating immediately after entering the facility (special considerations will be made for young athletes or Athletes requiring special assistance).
- Arena seating will be available in the designated sections only and rotated for sanitation purposes.
- Once the Athlete has skated their program, Spectators must leave the seating area and meet their athletes outside the area. Athletes will not be allowed in the stands/arena seating.
- Athletes and Spectators must leave the facility until results are posted on-line and may pick up awards at the awards area outside the facility.

## COACHES

- Coaches will be subject to temperature checks and screening questions daily.
- Masks are not required for fully vaccinated Coaches unless specifically required by Solar4America Ice Arena. Masks are required to be worn by Coaches who are not fully vaccinated regardless of the facility policies.
- Coaches should not stay in the building between events unless they have another skater already in the building.
- One (1) coach will be allowed per skater in the building.
- Coaches should observe social distancing when coaching their skaters during event warm-up.
- Results will be posted on-line as soon as possible after the event has concluded.
- Coaches are not permitted in the awards area.

## OFFICIALS

- Officials will be subject to temperature checks and screening questions daily.

- Masks are not required for fully vaccinated Officials unless specifically required by Solar4America Ice Arena. Masks are required to be worn by Officials who are not fully vaccinated regardless of the facility policies. In addition, Officials must observe and comply with U.S. Figure Skating's social distancing policy.
- Officials will enter and exit the building through a separate entrance and proceed upstairs to the Official's Prep Area or Official's Hospitality Area in Stanley's Restaurant.
- While pencils/pens (red) and clipboards will be available to Officials, Officials may choose to bring their own supplies to prevent cross-contamination.
- Disinfecting wipes will be available on the Judges' Stand for use to disinfect the Judges' terminals at the change of judges for each event.
- The Official's Prep Area is where all the Officials' competition paperwork and information will be available as well as storage for Officials' coats and other items.
- Stanley's Restaurant is where meals will be served for Officials in a segregated section; however, the restaurant will be open to the public so Officials should not leave any personal belongings in this area.
- Meals will be either pre-packaged meals or buffet served by hospitality volunteers.

## VOLUNTEERS

- Volunteers will be subject to temperature checks and screening questions daily.
- Masks are not required for fully vaccinated Volunteers unless specifically required by Solar4America Ice Arena. Masks are required to be worn by Volunteers who are not fully vaccinated regardless of the facility policies.
- Volunteers should check in with the Registration Desk and will be directed to their volunteer station.
- Volunteers serving as medical volunteers must complete the background screening and SafeSport Training.

## AWARDS

- Results will only be posted online at [\(insert link\)](#) as soon as possible after the event.
- Awards will be presented to 1<sup>st</sup> through 4<sup>th</sup> places.
- Medals will be awarded outside the rink during ice cuts or as soon as practical.
- Skaters and Spectators will exit the building immediately after their event and will pick up medals outside the rink.



## DISINFECTING PROCESS

- Skater Warm-up and Skater Prep Areas will be disinfected after each group has existed the area.
- Solar4America personnel will be cleaning and thoroughly disinfecting the rink, restrooms, and hospitality areas throughout the day.
- The Judges' Stand will have disinfecting wipes available for Officials to clean their stations before the start of their events.

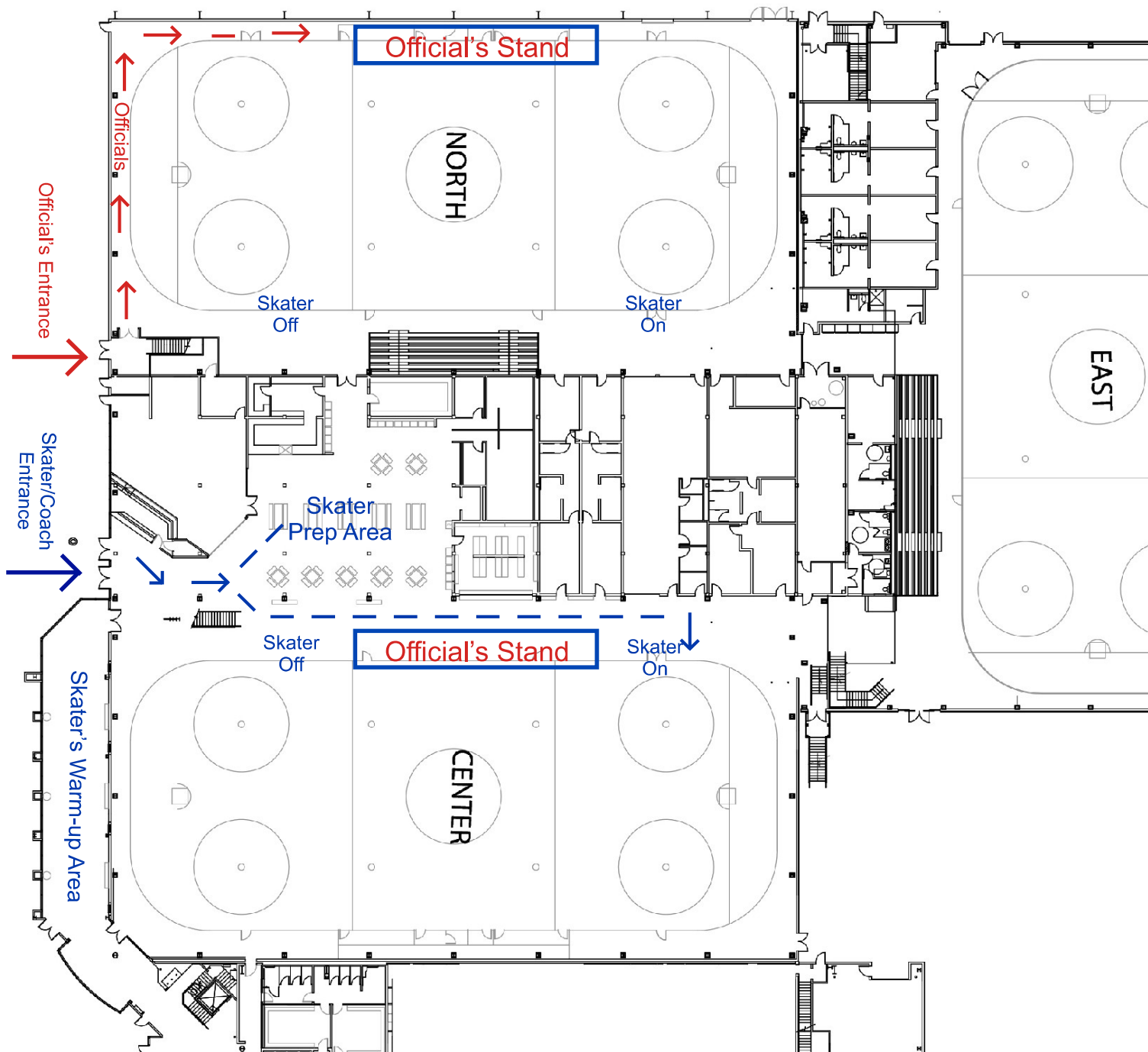

**Officials in Red**  
**Skaters/Coaches in Blue**

Sharks Ice at San Jose  
(First Floor)  
1500 South Tenth Street  
San Jose, California

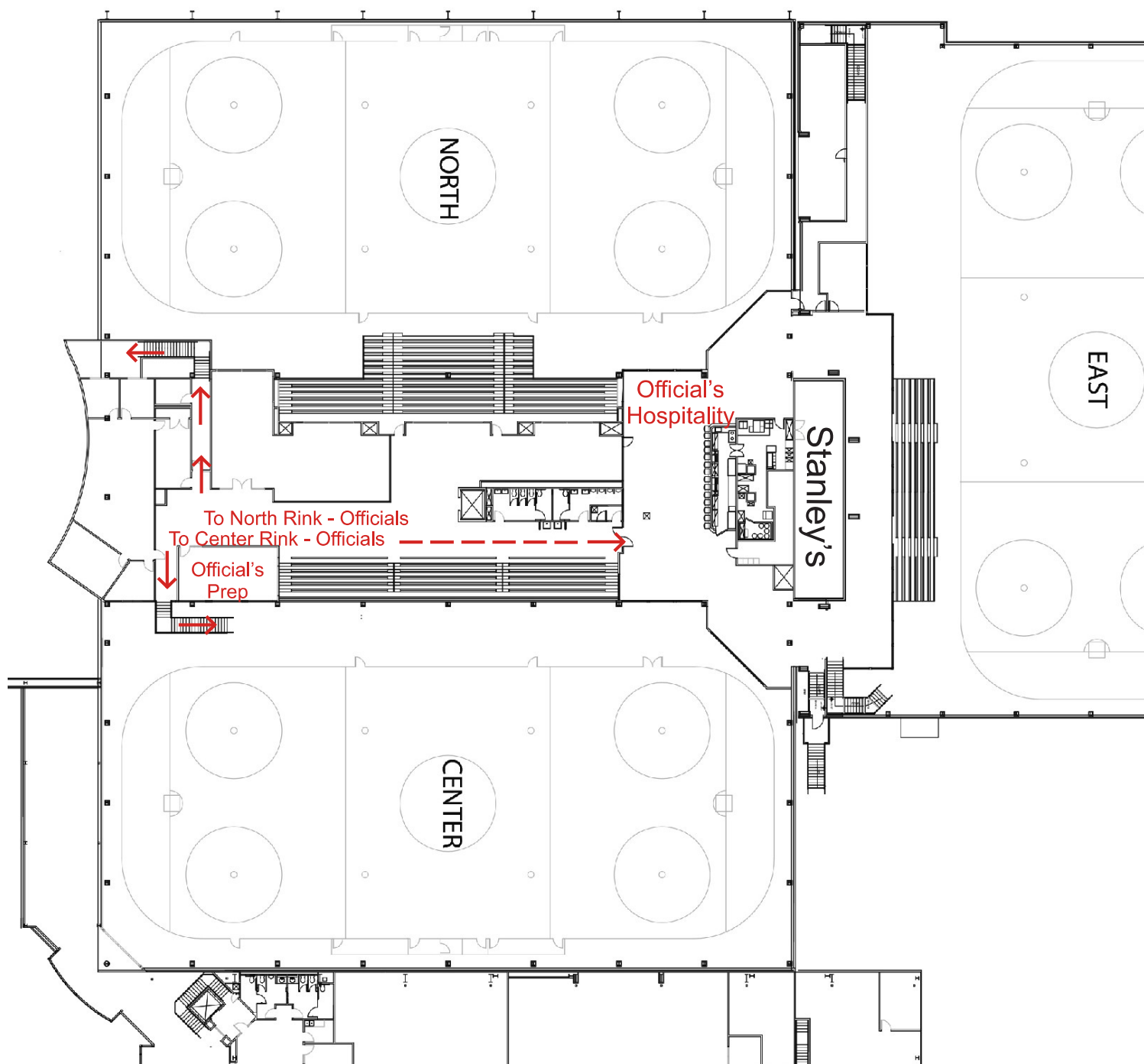

**Officials in Red**  
**Skaters/Coaches in Blue**

Sharks Ice at San Jose  
(Second Floor)  
1500 South Tenth Street  
San Jose, California